

Floor Plans | *First Floor*

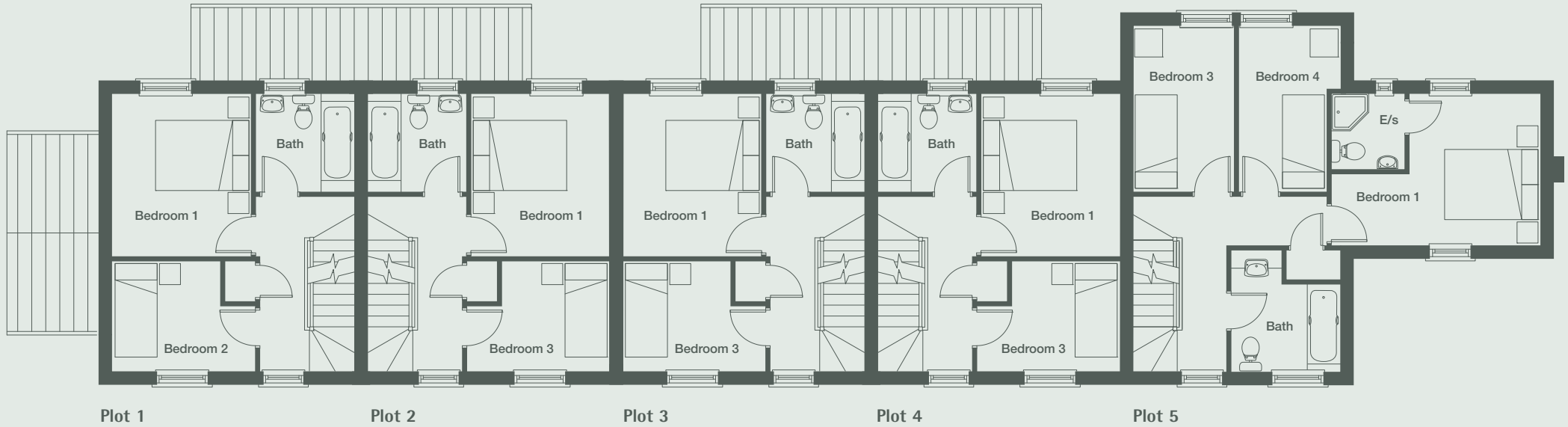

**Plot 1**

Bedroom 1	3.46m x 2.96m	11'3" x 9'7"
Bedroom 2	3.05m x 2.35m	10'0" x 7'7"

**Plot 2**

Bedroom 1	3.46m x 2.96m	11'3" x 9'7"
Bedroom 3	3.05m x 2.35m	10'0" x 7'7"

**Plot 3**

Bedroom 1	3.46m x 2.96m	11'3" x 9'7"
Bedroom 3	3.05m x 2.35m	10'0" x 7'7"

**Plot 4**

Bedroom 1	3.46m x 2.96m	11'3" x 9'7"
Bedroom 3	3.05m x 2.35m	10'0" x 7'7"

**Plot 5**

Bedroom 1	4.46m x 3.22m	14'6" x 10'6"
Bedroom 3	3.56m x 2.18m	11'7" x 7'1"
Bedroom 4	3.56m x 2.18m	11'7" x 7'1"